

# Xhorse VVDI Mini Key Tool Overview How Does It Work?

[VVDI Mini Key Tool](#) Overview: available with Wireless remote generation, Wired remote generation, Chip generation, the method to change the language and view the newest version number.

## First connect VVDI Mini Key Tool

Click "Select", and it will search for devices.

Long press the power button of the Mini Key Tool, and you can see the serial number on the screen, which means it has been turned on.

Meanwhile, you can see the icon of Mini Key tool in the Xhorse APP, tap the device icon to connect the device.

You will hear two beeps, it means it has been connected.



## Next, let's demonstrate how read and generate the chip.

Put the chip into the keyhole of Mini Key Tool.

Click on "Read transponder".

Okay, now the chip is recognized.

Then click on "Generate Transponder".

Choose a chip type to be generated, for example, generate ID46 chip, soon, the chip is generated successfully. Go back to click on "Read transponder" to read this chip, it is already the 46 chip that is generated just now.



Put the chip into the keyhole of Mini Key Tool.





Xhorsevdi

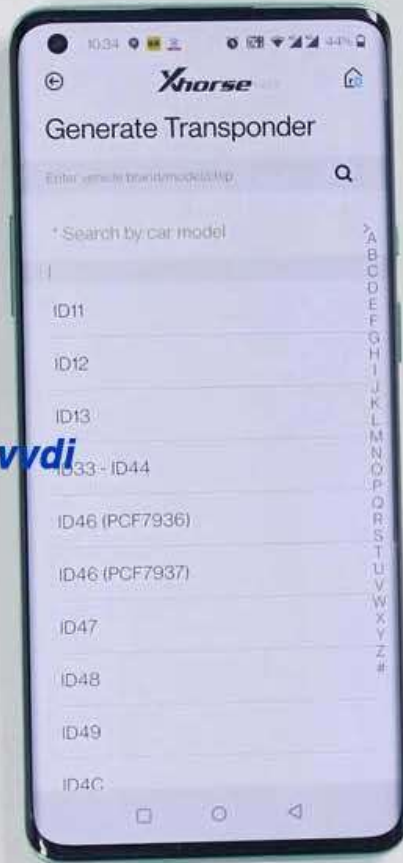

Xhorsevdi





Xhorsevdi

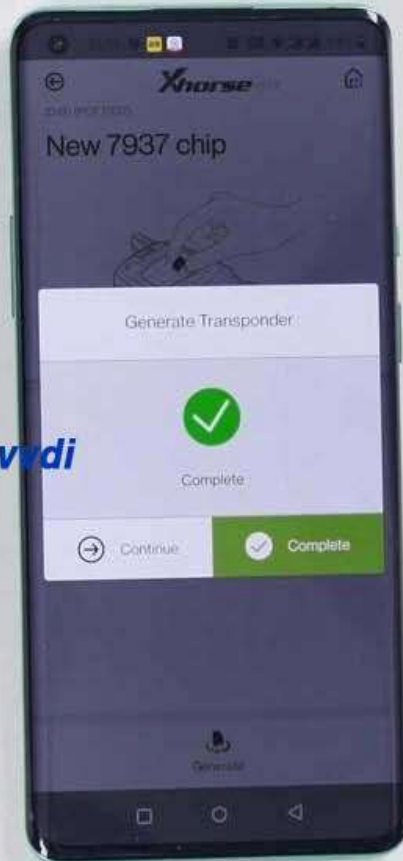

Xhorsevdi



Next, generate wireless remote.

This is a [wireless remote](#), put it into the keyhole of the Mini Key Tool.

Then select the car model you want to generate.

I have smart card so it will generate smart remote.

If it prompts failed to generate, please adjust the position of wireless smart remote, because the coil position may not be able to sense the chip.

Ok, generation succeed.





Xhorsevvd





**Next, generate wired remote.**

This is a wired remote, just remove its cover and you will see that there is a chip interface which can be connected to this remote programming cable.

Then you can generate keys by selecting "Vehicle remote", select the model you want to generate, click "generate", after the generation is complete, click OK.



Xhorsevvd

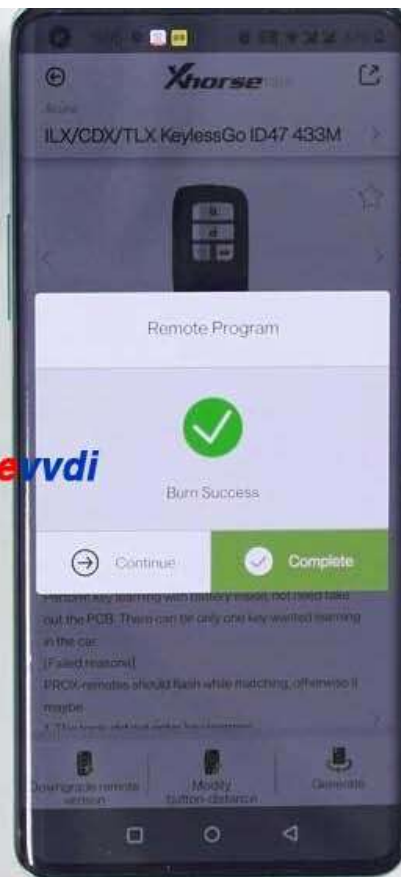

Xhorsevvd





box



MINI KEY TOOL



User's Manual



USB Cable



Remote Programming Cable





11:08 39%  
Xhorse  
Vehicle Remote My Account  
Enter the vehicle brand/ model/ remote type  
A  
Acura  
Aftermarket  
Audi  
B  
BYD MOTOR  
BAO JUN  
BISU Automobile  
BMW  
BORGWARD  
BYD  
Bentley  
ABCDEFGHIJKLMNOPQRSTUVWXYZ



**Finally, check the version and change the language**

Just click "Device information" to view the latest version.

If there is the latest version, it will let you update as soon as you open the software and you do not need to enter "Device information" to update.

How to change the language: Click "Select" and then "Language" to change the language you want.

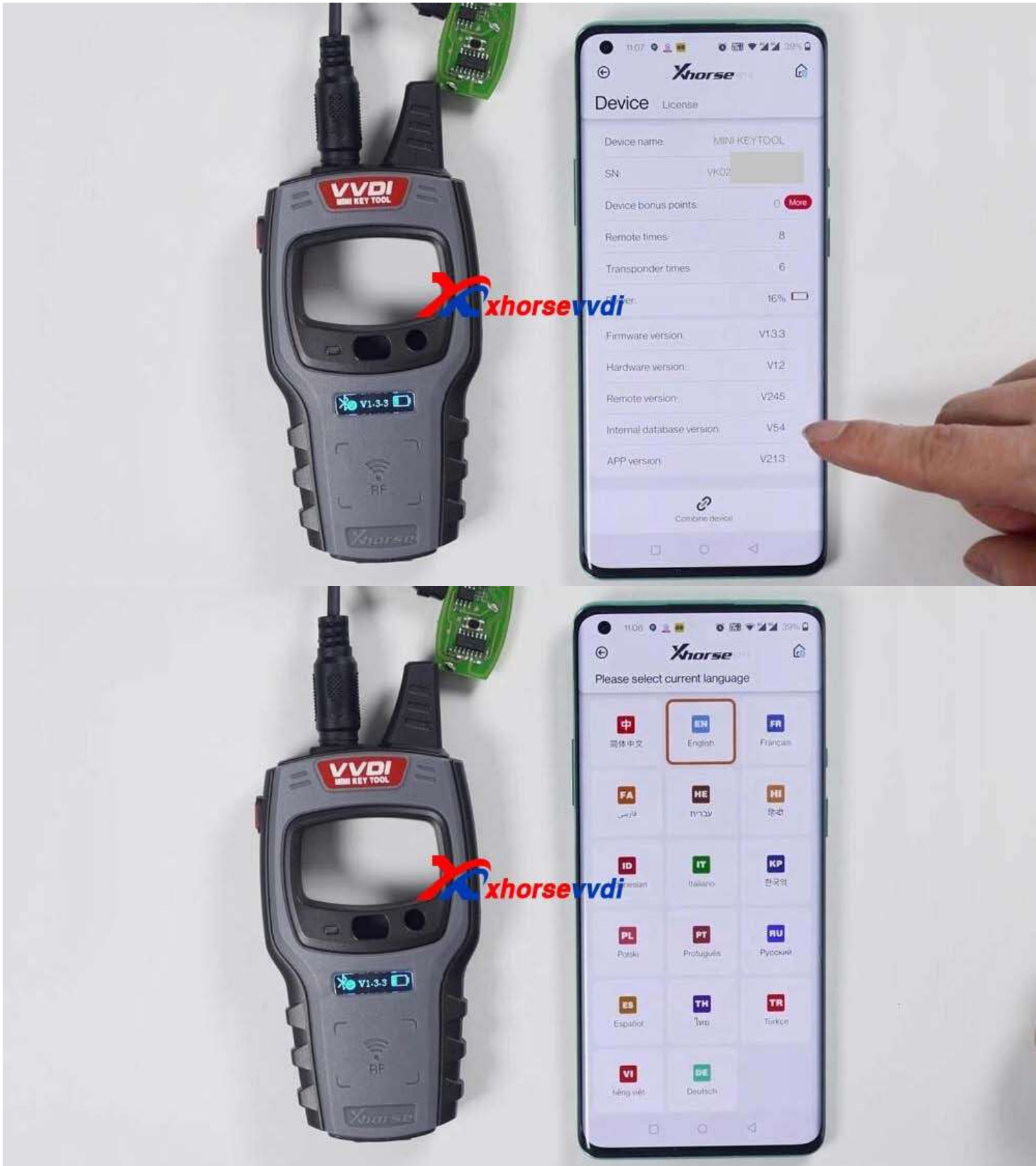

Enjoy!

